

Part Number: PT738-35240

Kit Contents

Item #	Quantity Reqd.	Description
1	1	LH Running Board (51084-YY090)
2	1	RH Running Board (51083-YY090)

Hardware Bag Contents

Item #	Quantity Req'd.	Description

Additional Items Required For Installation

Item #	Quantity Req'd.	Description

Conflicts

None

Recommended Tools

Personal & Vehicle Protection	Notes
Safety Glasses	
Special Tools	Notes
Installation Tools	Notes
½” Ratchet	6” extension
12mm Socket	
Torque Wrench	0-50 N-M
Special Chemicals	Notes

General Applicability

MY24 and newer Tacoma, Tacoma HV D-Cab models

Recommended Sequence of Application

Item #	Accessory

*Mandatory

Vehicle Service Parts (may be required for reassembly)

Item #	Quantity Req'd.	Description
1	16	BOLT, w/ WASHER (90119-A0582)

Legend



 **STOP:** Damage to the vehicle may occur. Do not proceed until process has been complied with.



 **OPERATOR SAFETY:** Use caution to avoid risk of injury.



 **CAUTION:** A process that must be carefully observed in order to reduce the risk of damage to the accessory/vehicle and to ensure a quality installation.



 **TOOLS & EQUIPMENT:** Used in Figures calls out the specific tools and equipment recommended for this process.



REVISION MARK: This mark highlights a change in installation with respect to previous issue.



 **SAFETY TORQUE:** This mark indicates that torque is related to safety.



REGULATORY MARK: This mark indicates the component is related to regulatory compliance

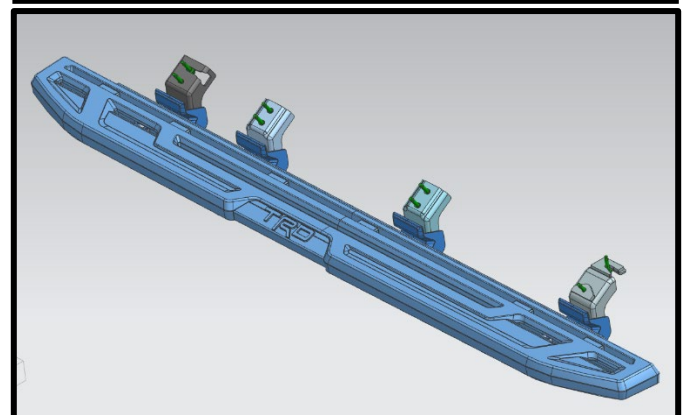

Care must be taken when installing this accessory to ensure damage does not occur to the vehicle. The installation of this accessory should follow approved guidelines to ensure a quality installation.

These guidelines can be found in the "Accessory Installation Practices" document.

This document covers such items as:-

- Vehicle Protection (use of covers and blankets, cleaning chemicals, etc.).
- Safety (eye protection, rechecking torque procedure, etc.).
- Vehicle Disassembly/Reassembly (panel removal, part storage, etc.).
- Electrical Component Disassembly/Reassembly (battery disconnection, connector removal, etc.).

Please see your Toyota dealer for a copy of this document.

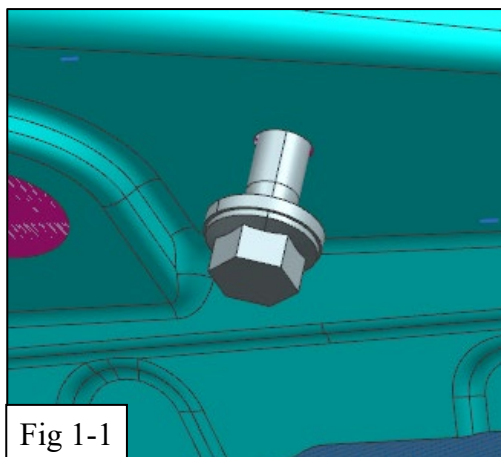

1. Running Board Installation RH Side

- Using a 12mm socket, remove 16 OE Hex bolts (90119-A0582 BOLT, W/WASHER) from underneath the vehicle in locations 1, 2, 3, 4 per Fig. 1-2 (8 per side). Save them for later use.
- Insert previously removed bolt (90119-A0582 BOLT, W/WASHER) into inner weld nut hole Fig. 1-1 & Fig. 1-2.

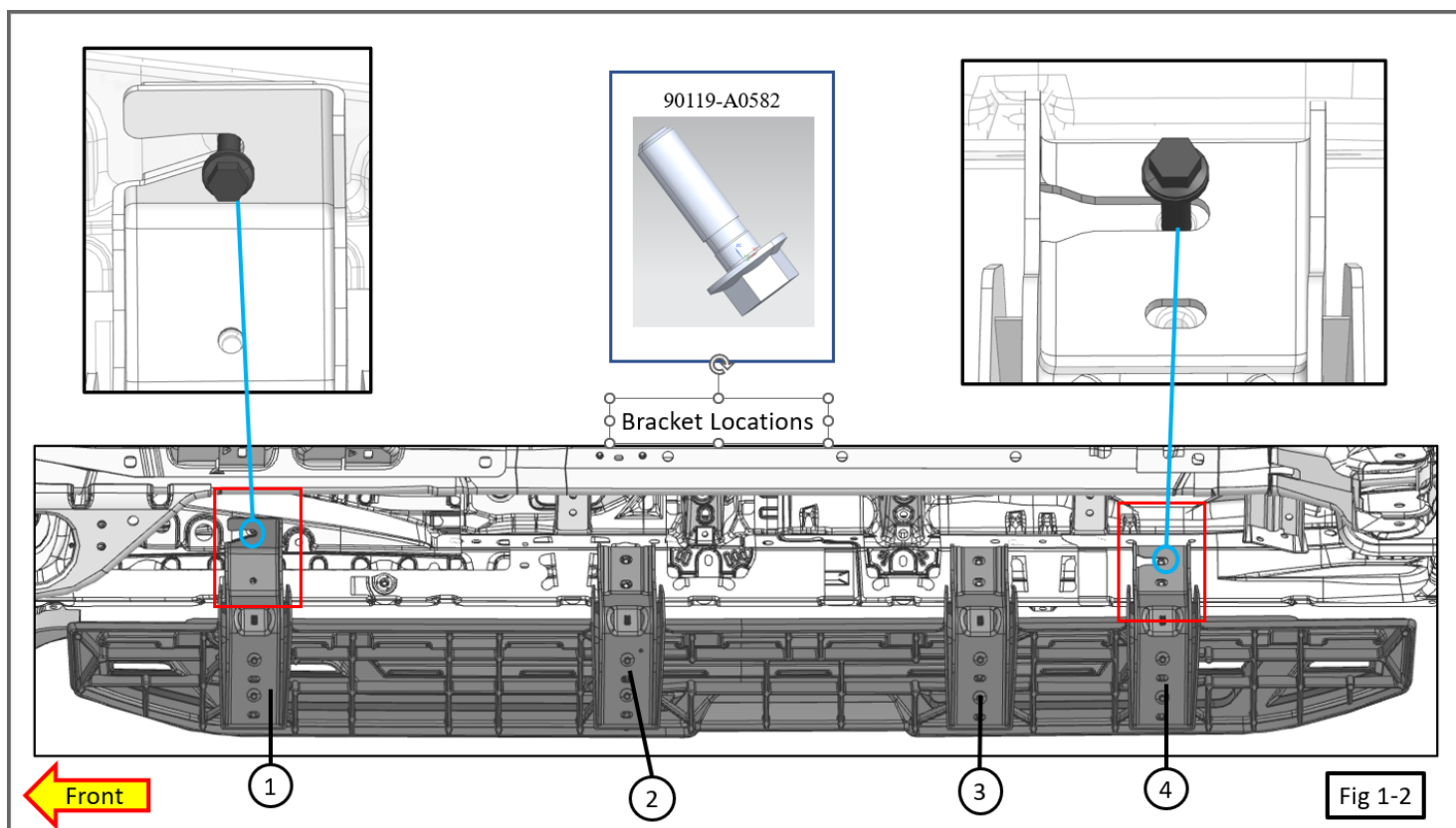

c)

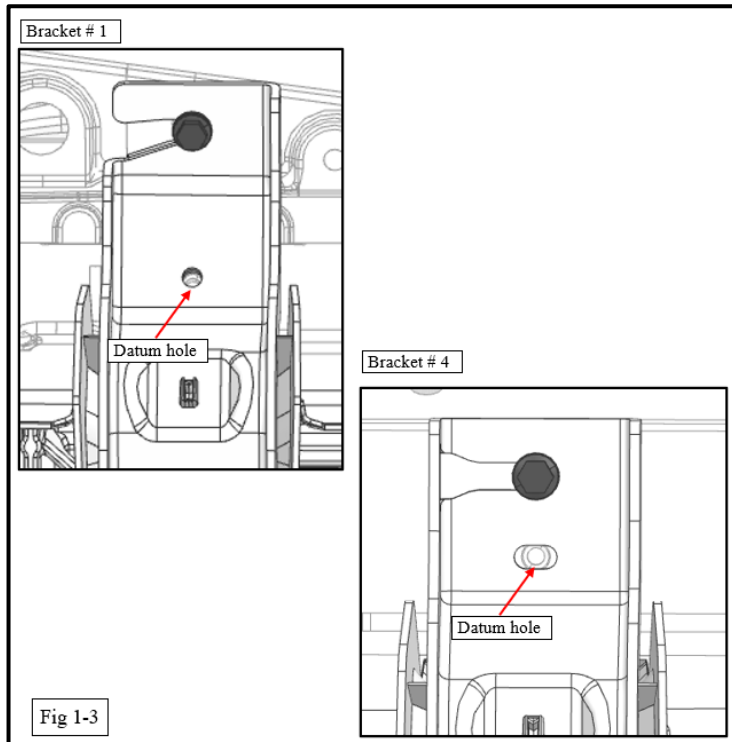

(c) Hang the running board in position using the bolt and the key-slot in bracket position #1 and #4. Fig 1-3.

(d) Push up and align the Front Bracket outer datum hole to the hole in the vehicle.

Install and torque the two bolts to 34N.m (25.07 lb.-ft).

Repeat on rear bracket. Fig. 1-3 & 1-4.

(e) Install the final 4 bolts (2 per bracket) and torque each of them to 34 Nm. (25.07 lb.-ft).

2. Running Board Installation RH Side

(a) Repeat steps 2(a) to 2(e) for the LH side of the vehicle.

3. Retorque All Bolts

Re-torque all bolts to 34 N-m (25.07 lb.-ft).

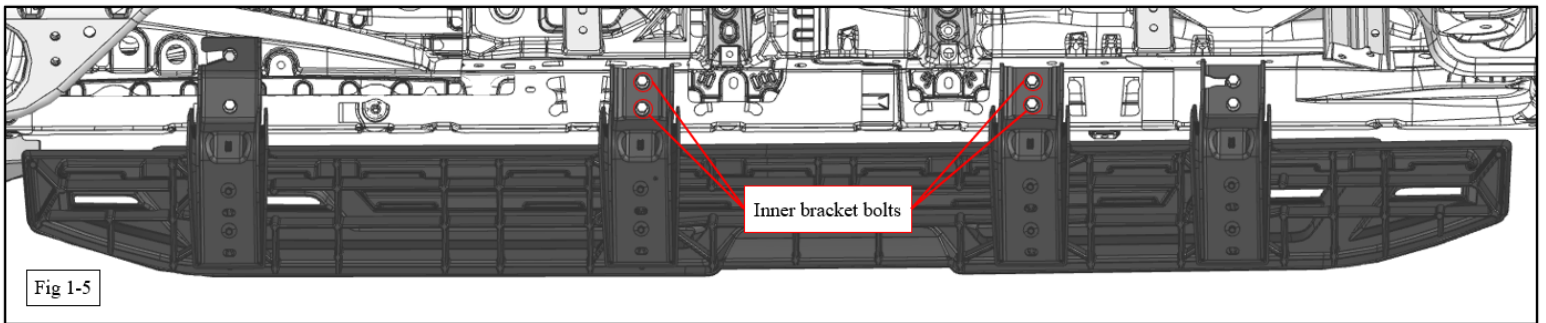
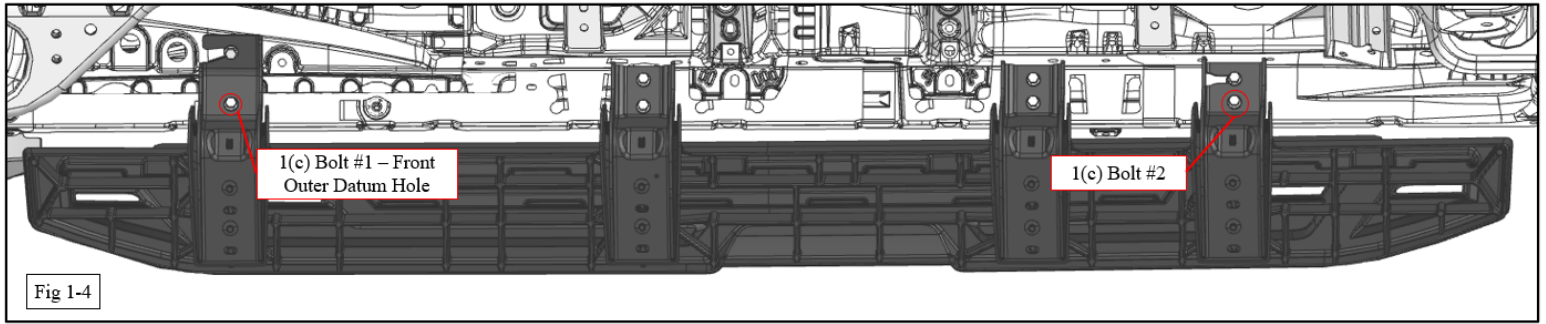

TOYOTA TACOMA, HV 2024 - RUNNING BOARD

Checklist - these points **MUST** be checked to ensure a quality installation.

Check:	Look For:
<u>Accessory Function Checks</u> <input type="checkbox"/> Running board alignment <input type="checkbox"/> <input type="checkbox"/> <input type="checkbox"/>	Ensure running board is centered on the vehicle
<u>Vehicle Function Checks</u> <input type="checkbox"/> <input type="checkbox"/> <input type="checkbox"/>	
<u>Vehicle Appearance Check</u> <input type="checkbox"/> After accessory installation perform a visual inspection.	Ensure no damage (including scuffs and scratches) was caused during the installation process.